

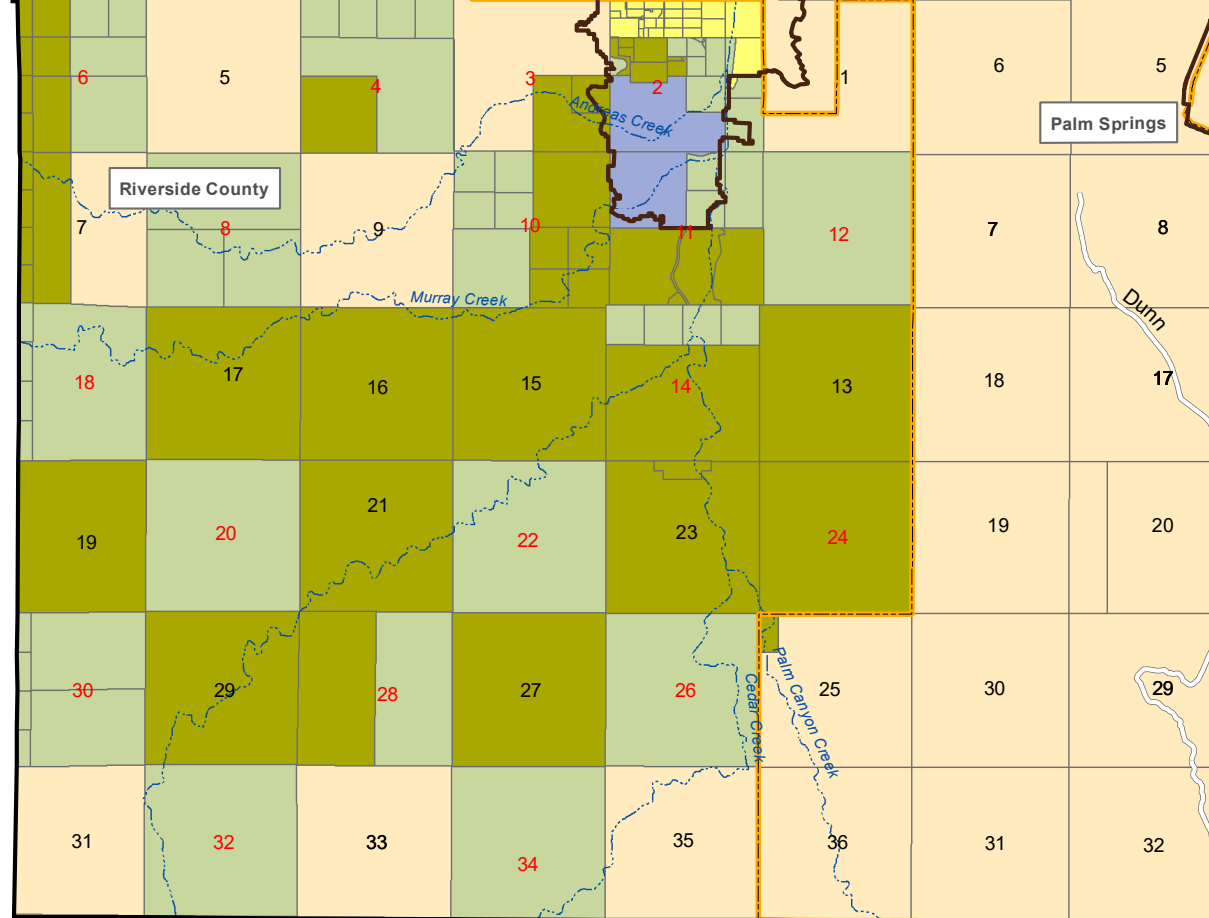

# AGUA CALIENTE INDIAN RESERVATION TRIBAL LAND USE ORDINANCE ZONING DISTRICTS AS OF MARCH 05, 2019

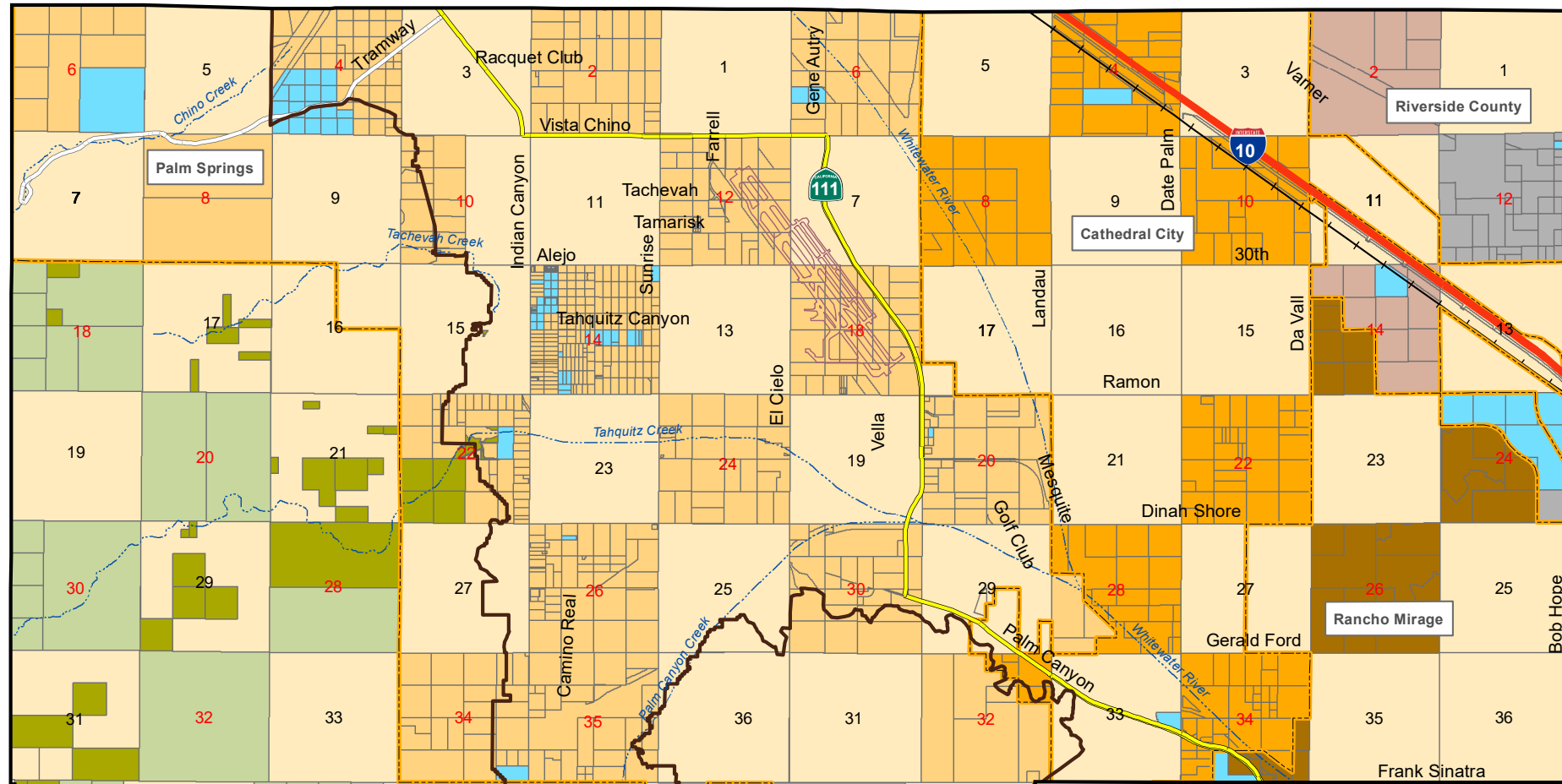

### Zoning Districts

- Land Use Contract, Palm Springs
- Land Use Contract, Cathedral City
- Land Use Contract, Rancho Mirage
- Land Use Contract, Riverside County
- Specific Plan
- Tribal Enterprise
- Low Density Residential
- Rural Residential
- Tribal Reserve
- Heritage Park
- Off Reservation

- Mountains & Canyons Conservation Area
- Interstate 10
- State Highways
- Railroads
- Intermittent Streams
- Whitewater River
- Political Jurisdictions
- 14 Reservation Sections

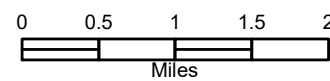

Agua Caliente Band of Cahuilla Indians  
5401 Dinah Shore Dr. Palm Springs CA, 92264  
Geospatial Information Services  
(760) 883 - 1911/Fax (760) 883-1937

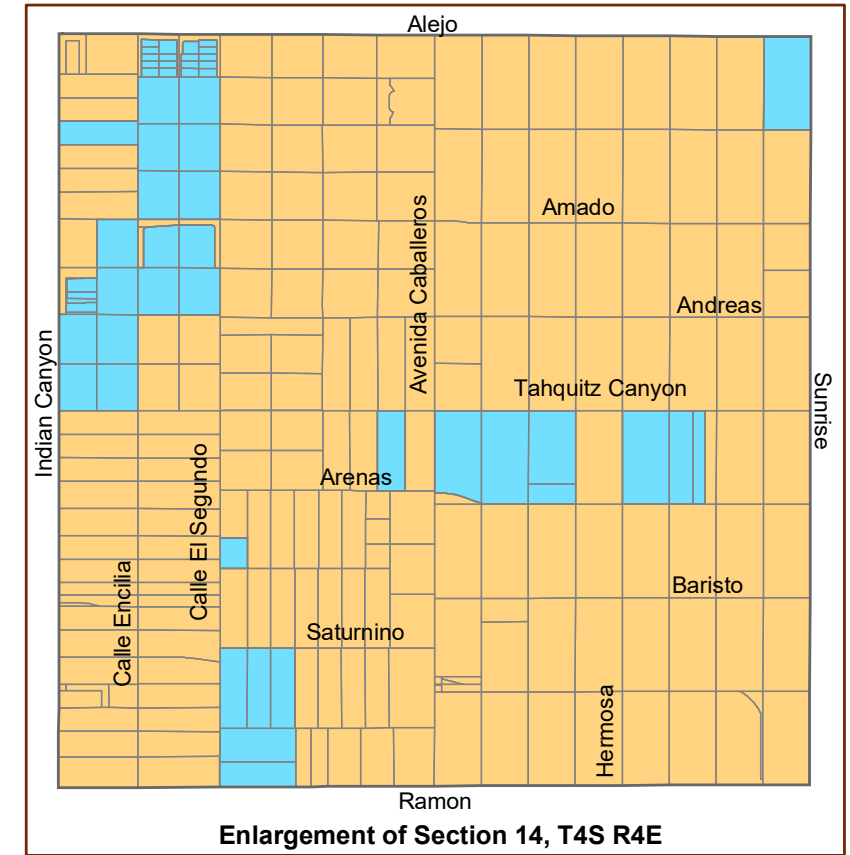

Enlargement of Section 14, T4S R4E

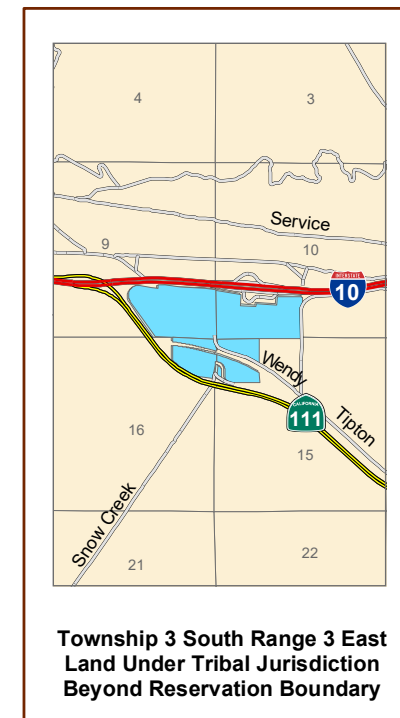

Township 3 South Range 3 East  
Land Under Tribal Jurisdiction  
Beyond Reservation Boundary

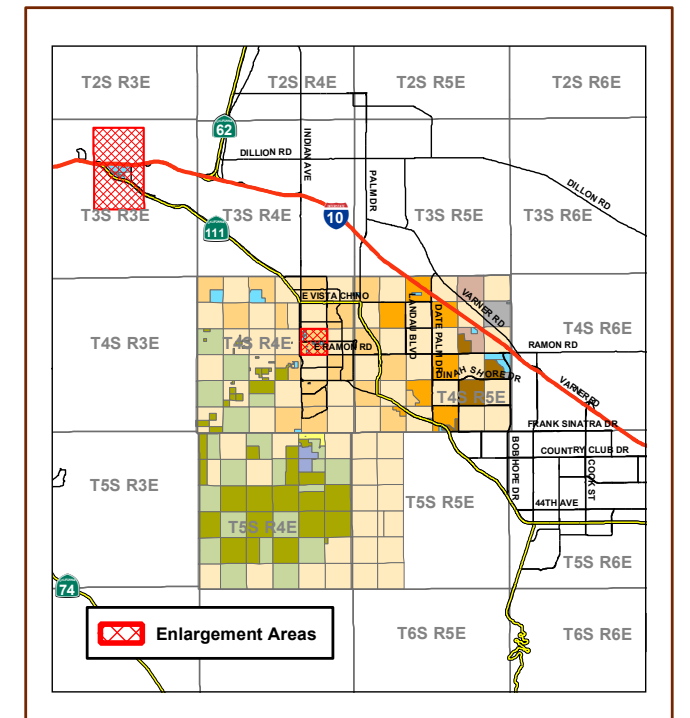

Enlargement Areas